

BILLING:

Company Name _____
 Contact Person _____
 Street Add. or P.O. Box No. _____
 City _____ State _____ Zip _____
 Ph. No. _____ Fax No. _____

SHIP TO:

Company Name _____
 Street Add. (No P.O. Box No.) _____
 City _____ State _____ Zip _____
 Attn. _____ Phone No. _____
 Special Shipping Instructions _____

Axle Order Information

Type of Rear End

(9" Ford, 12 Bolt Chevy, ect.)

Measuring for Rear End Width

- D. Wheel to wheel width
- E. Housing flange to housing flange
- F. Driver side housing flange to pinion center
- G. Passenger side housing flange to pinion center

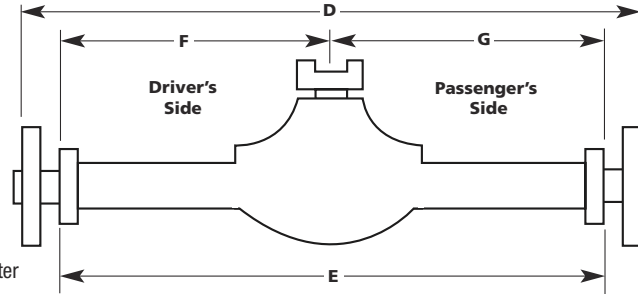

Measurements
(from diagram)

D _____
 E _____
 F _____
 G _____

Type of Housing Ends

(see diagram at right or page 37)



SMALL FORD

BIG FORD

NEW STYLE BIG FORD

OLDS/PONTIAC

CHEVY 10/12 BOLT
ALL EXCEPT FOR
IMPALA & TRUCK

Measuring for Individual Axle Length

10 or 12 Bolt Chevy and 8.8 Ford

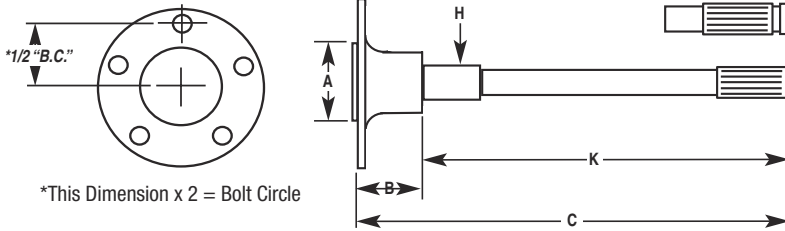

Type of Rear End

(9" Ford, 12 Bolt Chevy, ect.)

Measurements
(from diagram)

Bolt Circle

Stud Type

- Screw In
- Press In
- 1/2"
- 5/8"

If using disc brakes,
list axle flange diameter needed _____

Spline Count

If spool, list manufacturer _____

Driver's Side Dimensions _____
 Passenger's Side Dimensions _____
 C _____
 K _____

Note: All custom alloy are tapped 1/2" x 20, unless otherwisw specified.

PART NUMBER	QUANTITY	DESCRIPTION	PRICE
			\$

Payment Method

- Check or Money Order enclosed
- Credit Card

Please charge my order, including shipping and handling charges to:

Card Number

Exp. Date Mo. /Yr.

Name of Cardholder (Please print clearly)

Cardholder signature

TOTAL PRICE FROM ABOVE	\$
FL RESIDENTS ADD 6% SALES TAX	\$
TOTAL	\$